

1 3/8 Inch Tubing Cut List for 18 ft. 9 3/4 in. X 40 Foot Canopy using a 20X40 Foot Tarp

Medium Gable Peak Canopy with valance (110 Degree slope, 4 inch rise/foot)

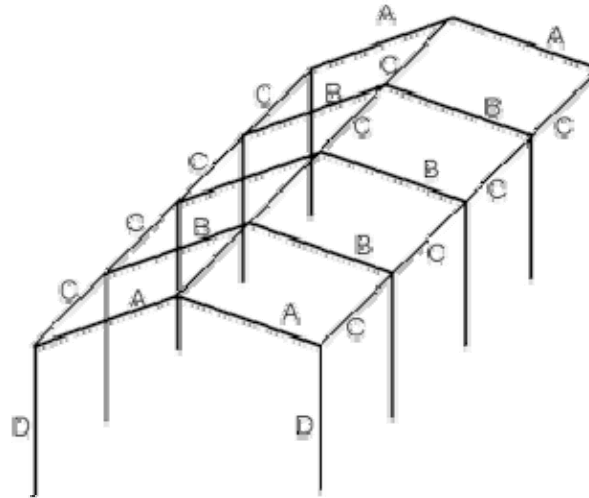

Tubing requirements:

Cut into the follow pieces:

Purchase 1 3/8 inch Chain link fence tubing

Chain link fence tubing can be purchased in lengths up to 20 feet or can be purchased precut into the following sizes:

Label	Name	Number of pieces	Length of Pieces
A	End Roof Rafters	4	10 ft.
B	Middle Roof Rafters	6	9 ft. 10 in.
C	Roof Ridge and Sides	12	10 ft.
D	Legs (Note 1)	10	7 ft.

Note 1: Legs can be cut to any desired length. Structures with side height greater than 8 feet should only be constructed with 1 3/8, 1 5/8 or 1 7/8 inch tubing materials.

Approximate final dimensions:

These are approximate final dimensions. They may vary slightly with variations in cut lengths, tarp variations and assembly.

Tarp Size	20X40
Peak Height	10 ft. 5 3/4 in.
Side Height	7 ft.
Front Opening Width	18 ft. 9 3/4 in.
Length	40 ft.

⚠️ All canopy shelters should be considered temporary structures and are not designed to withstand acts of nature such as heavy wind and snow. Anchoring of canopies is strongly recommended. Failure to anchor is unsafe and can lead to property damage. [Click Here](#) to see what can happen when canopies are not securely anchored.

Check out our Claw, auger and duckbill anchors on the [accessories](#) pages.